

INSTALLATION INSTRUCTIONS

Original Issue Date: 12/95

Model: 10/12 kW

Market: Industrial

Subject: Weather Housing Kits PA-226589, PA-226590

Model	Kit
10RY, 12RY	PA-226589
10RZ, 12RZ	PA-226590

Introduction

The weather housing kit provides weather protection for generator sets installed outdoors. Lockable housing panels prevent unauthorized personnel from tampering with the generator set.

The installed weather housing kit is shown in Figure 1. Refer to the assembly drawing in Figure 3 to identify kit components and their locations.

Note: Lift the weather housing and generator set together as one unit; refer to the generator set installation manual guidelines.

Note: The generator set skid and front shroud are predrilled to accept the weather housing components.

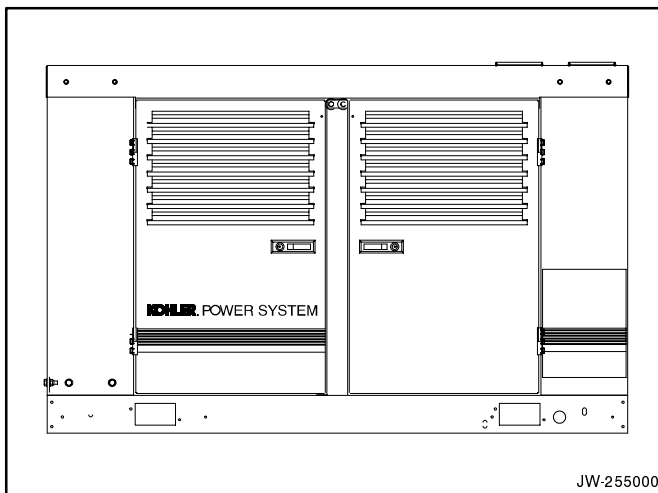

Figure 1 Installed Weather Housing Kit

Safety Precautions

Observe the following safety precautions while installing the kit.

⚠ WARNING



Accidental starting.
Can cause severe injury or death.

Disconnect the battery cables before working on the generator set. Remove the negative (-) lead first when disconnecting the battery. Reconnect the negative (-) lead last when reconnecting the battery.

Disabling the generator set. Accidental starting can cause severe injury or death. Before working on the generator set or connected equipment, disable the generator set as follows: (1) Move the generator set master switch to the OFF position. (2) Disconnect the power to the battery charger. (3) Remove the battery cables, negative (-) lead first. Reconnect the negative (-) lead last when reconnecting the battery. Follow these precautions to prevent starting of the generator set by an automatic transfer switch, remote start/stop switch, or engine start command from a remote computer.

⚠ WARNING



Hot engine and exhaust system.
Can cause severe injury or death.

Do not work on the generator set until it cools.

Servicing the exhaust system. Hot parts can cause severe injury or death. Do not touch hot engine parts. The engine and exhaust system components become extremely hot during operation.

Installation

1. Place the generator set master switch in the OFF position.
2. Disconnect the power to the battery charger, if equipped.
3. Disconnect the generator set engine starting battery(ies), negative (-) lead first.
4. **RY models:** Attach the rail extensions (254862) to the skid on the alternator end using screws (X-125-5) and nuts (X-101-16).
5. Secure the housing support brackets (273977 and 273976) to the alternator end of the generator set skid using screws (X-125-5), washers (X-25-85), and nuts (X-101-16). Final tighten the hardware. See Figure 3.
6. Position the rear housing shroud (256833) on the skid. Secure it to the mounting brackets with screws (X-125-5), washers (X-25-85), and nuts (X-101-16).
7. Position the weather housing roof (256834) over the top of the generator set. Verify that the roof openings align with the silencer and radiator ports on the generator set.
8. Secure the roof to the radiator guard and rear shroud using screws (X-6216-1) through the predrilled holes.
9. Install two 4.5 in. plugs (253268) into the roof holes.
10. Secure the housing panels (265835) to the skid using drill screws (X-794-1) and washers (X-25-40).
11. Secure the housing panels to the roof using screws (X-465-16), washers (X-25-73), and nuts (X-101-8).
12. Install the latches (253373) into the door openings using the screws and brackets supplied with the latches. See Figure 2.
13. Install two left-hand hinges (297600) and two right-hand hinges (297601) to the radiator guard using screws (295098), washers (X-25-36), and retainer nuts (X-6204-3).
14. Install two left-hand hinges (297600) and two right-hand hinges (297601) to the rear shroud sides using screws (295098), washers (X-25-36), and retainer nuts (X-6204-3).
15. Install two left-hand hinges (297600) to the rear shroud using screws (295098), washers (X-25-36) and retainer nuts (X-6204-3).
16. Install two plastic plugs (253723) in each door to reduce vibration. Locate the plugs on the inside edge where the doors make contact with the housing support.
17. Attach the doors (256451 and 256836) to the hinges using screws (295098), washers (X-25-36), and flange nuts (X-6210-5). Center the doors vertically in the openings before tightening all hinge screws.
18. Final tighten all mounting hardware.
19. Attach the decals to a clean, dry surface in the locations shown in Figure 3.
20. Check that the generator set master switch is in the OFF position.
21. Reconnect the generator set engine starting battery, negative (-) lead last.
22. Reconnect the power to the battery charger, if equipped.

Note: Mount the hinge half with the pin onto the shroud.

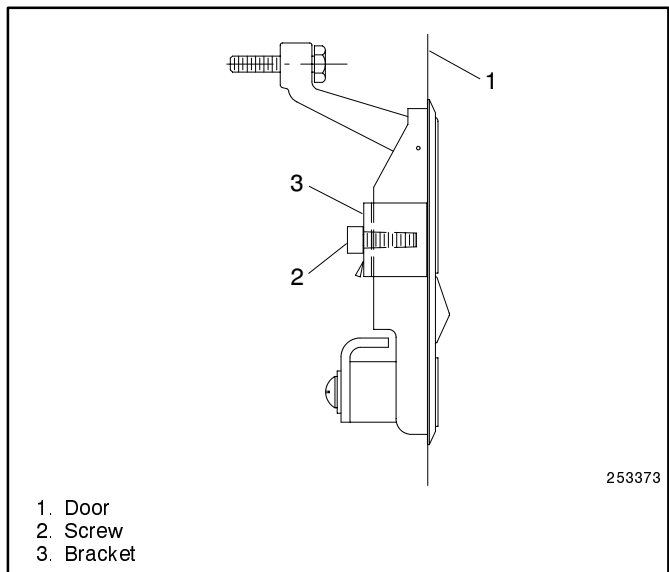
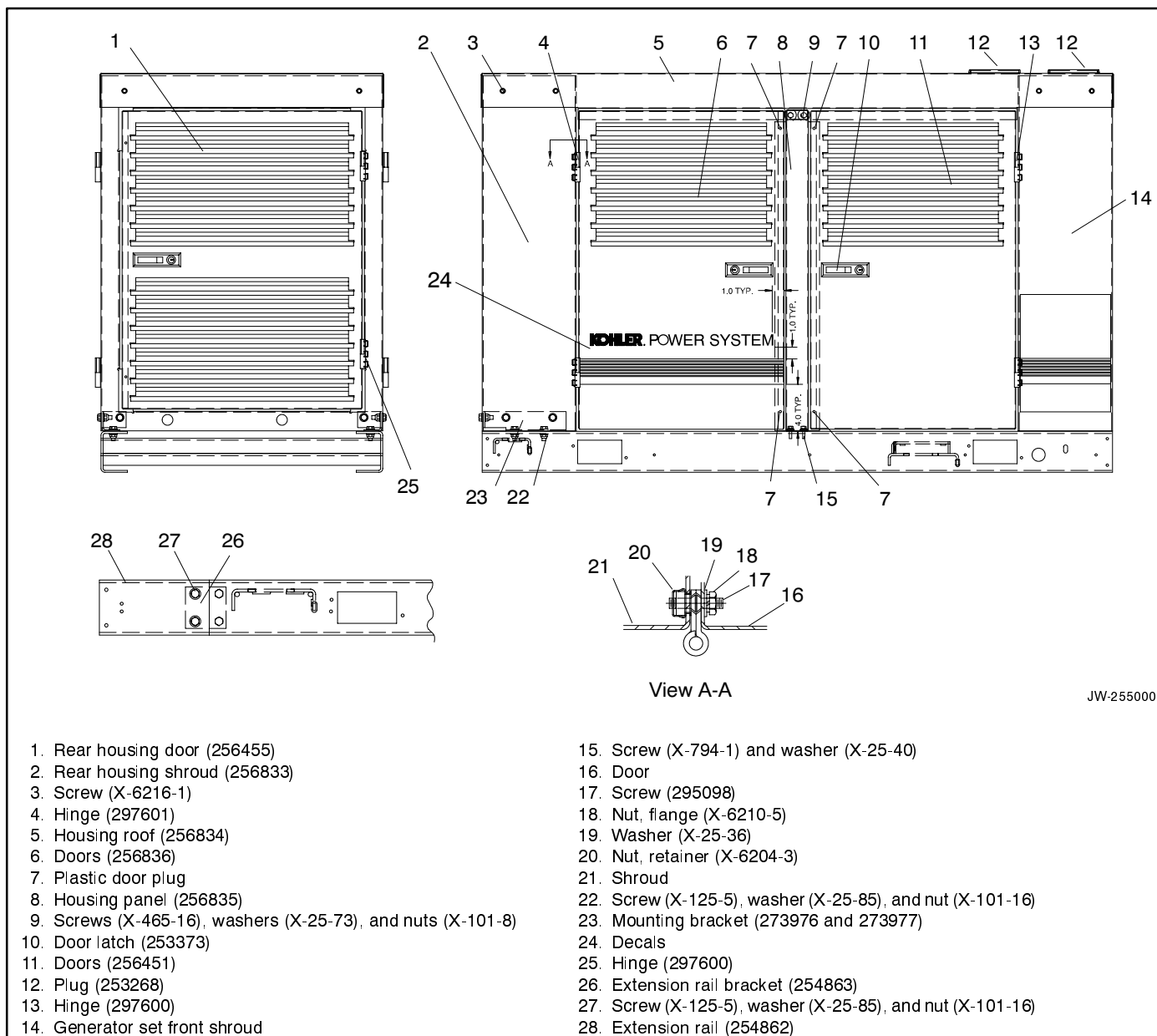

Figure 2 Door Latch



JW-255000

Figure 3 Weather Housing Assembly

Weather Housing Kit

Parts List				
Kits: PA-226589, PA-226590			Unique Parts	
Qty.	Description	Common Parts	PA-226589	PA-226590
60	Washer, plain, o.d.=0.5 in.	X-25-36		
4	Washer, plain, o.d.=0.625 in.	X-25-40		
4	Washer, plain, o.d.=1.0 in.	X-25-73		
	Washer, plain, o.d.=0.687 in.		(24) X-25-85	(20) X-25-85
4	Nut, elastic stop	X-101-8		
	Nut, elastic stop, 5/16		(18) X-101-16	(10) X-101-16
	Screw, 5/16-18 x 1.0		(18) X-125-5	(10) X-125-5
2	Plug, button	X-301-24		
4	Screw, h.c., 1/4-20 x 0.75 in.	X-465-16		
4	Screw, drill hex.	X-794-1		
30	Nut, retainer, #10-24	X-6204-3		
30	Nut, flange, #10-24	X-6210-5		
13	Screw, Phillips hex., #10-24 x 0.5 in.	X-6216-1		
2	Decal, stripes	X-6232-1		
2	Decal, logo	X-6246-6		
2	Plug, 4.5 in.	253268		
5	Latch, door	253373		
10	Plug, plastic door, 0.44 in.	253723		
2	Rail, extension		254862	
2	Bracket, extension rail		254863	
1	Bracket, water bottle	254919		
2	Door, housing	256451		
1	Door, rear housing	256455		
1	Shroud, rear housing	256833		
1	Roof, housing	256834		
2	Panel, housing	256835		
2	Door, housing	256836		
1	Bracket, housing support l.h.	273976		
1	Bracket, housing support r.h.	273977		
60	Screw, FHM, #10-24 x 0.5 in.	295098		
6	Hinge, split	297600		
4	Hinge, split	297601		