

## INSTALLATION INSTRUCTIONS

Original Issue Date: **9/96**

Model: **10/12CC/CZ/RV/RZ**

Market: **Mobile and Industrial**

Subject: **Silencer and Mounting Kit (PA-254964)**

Observe the following safety precautions when installing this kit. Refer to the Parts List and Figure 1 for parts identification and location.



**Accidental starting.**  
**Can cause severe injury or death.**

Disconnect battery cables before working on generator set (disconnect negative lead first and reconnect it last).

**Disabling generator set. Accidental starting can cause severe injury or death.** Turn generator set master switch to OFF position, disconnect power to battery charger, and remove battery cables (remove negative lead first and reconnect it last) to disable generator set before working on the generator set or connected equipment. The generator set can be started by an automatic transfer switch or remote start/stop switch unless these precautions are followed.

### ⚠ WARNING

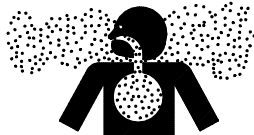

**Carbon monoxide.**  
**Can cause severe nausea, fainting, or death.**

The exhaust system must be leakproof and routinely inspected.

**Carbon monoxide symptoms. Carbon monoxide can cause severe nausea, fainting, or death.** Carbon monoxide is a poisonous gas which is present in exhaust gases. Carbon monoxide poisoning symptoms include but are not limited to the following:

- Light-headedness, dizziness
- Physical fatigue, weakness in joints and muscles
- Sleepiness, mental fatigue, inability to concentrate or speak clearly, blurred vision
- Stomachache, vomiting, nausea

If experiencing any of these symptoms and carbon monoxide poisoning is possible, affected persons should seek fresh air immediately. They should remain active. They should not sit, lie down, or fall asleep. Alert others to the possibility of carbon monoxide poisoning. If the condition of affected persons does not improve within minutes of breathing fresh air, they should seek medical attention.

### ⚠ WARNING

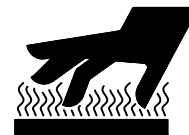

**Hot engine and exhaust system.**  
**Can cause severe injury or death.**

Do not work on generator set until it is allowed to cool.

**Servicing exhaust system. Hot parts can cause severe injury or death.** Do not touch hot engine parts. An engine becomes hot while running and exhaust system components become extremely hot.

# Installation

1. Place the generator set master switch in the OFF position.
2. Disconnect generator set engine starting battery, negative (–) lead first.

## NOTE

Handtighten all components until completion of preliminary installation. When installation of silencer kit is complete, finish tightening kit components.

3. Remove housing doors (if equipped) to expose generator set.
4. Attach 90° elbow (X-215-21) to engine exhaust manifold outlet.
5. Install reducer bushing (X-202-48) into 90° elbow.
6. Install pipe (X-210-25) into reducer bushing.
7. Install pipe elbow (X-215-20) into pipe.
8. Install bracket (254962) to exhaust manifold using washer (X-25-85) and screw (X-125-23) to secure.
9. Install bracket (254963) to bracket on exhaust manifold using washers (X-25-40), nuts (X-6210-2), and screws (X-465-18) to secure.
10. Install coupling (X-216-30) into silencer's (150213) outlet.
11. Secure silencer inlet to pipe elbow installed in Step 7.
12. Secure coupling attached to silencer outlet to bracket (254963) using U-bolt (X-397-3).

13. Attach exhaust pipe (X-210-26) to silencer outlet.
14. Check that the generator set master switch is in the OFF position.
15. Reconnect generator starting battery, negative (–) lead last.
16. Start generator set and inspect exhaust system for leaks. Stop generator set. Eliminate exhaust leakage (if any) before proceeding to next step.
17. Replace generator housing doors (if equipped) and return generator master switch to normal position.

## Silencer and Mounting Kit

Parts List		
Kit: PA-254964		
Qty.	Description	Part Number
1	Screw, H.C. (5/16-18 x 0.62)	X-125-23
1	Bushing, reducer	X-202-48
1	Pipe (6 in.)	X-210-25
1	Pipe (16.5 in.)	X-210-26
1	Elbow, pipe	X-215-20
1	Elbow, 90°	X-215-21
1	Coupling	X-216-30
4	Washer, plain (.281 x .625 x .065)	X-25-40
1	Washer, plain (.344 x .687 x .065)	X-25-85
1	Bolt, U	X-397-3
2	Screw, hex. (1/4-20 x 0.88)	X-465-18
2	Nut, whiz (1/4-20) zinc	X-6210-2
1	Silencer	150213
1	Bracket, silencer (3.00 x 2.75)	254962
1	Bracket, silencer (2.07 x 1.75)	254963

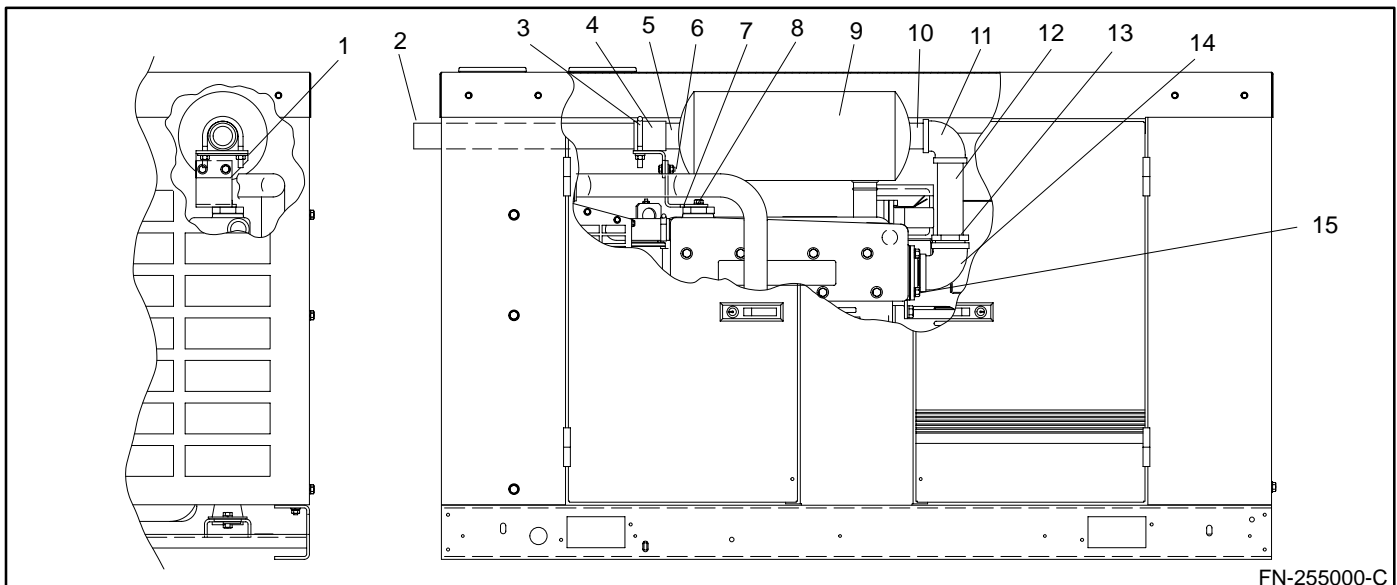

1. Bracket (254963)
2. Pipe (X-210-26)
3. U-bolt (X-397-3)
4. Coupling (X-216-30)
5. Silencer outlet
6. Screw (X-465-18) qty. 2, washer (X-25-40) qty. 4, and nut (X-6210-2) qty. 2
7. Bracket (254962)
8. Screw (X-125-23) and washer (X-25-85)
9. Silencer (150213)
10. Silencer inlet
11. Pipe elbow (X-215-20)
12. Pipe (X-210-25)
13. Reducer bushing (X-202-48)
14. 90° elbow (X-215-21)
15. Engine exhaust manifold outlet

**Figure 1. Silencer and Mounting Installation**