



Flashing Board Kit 228672 for 2.25MBM, 3.5MBM, and 5MBM (Briggs-powered), and 3.5MM, 4MM, 5MM, 5CM, 6CM and 6MM (Kohler-powered) Portable Generator Sets

The Flashing Board Kit involves replacing the current flashing board (D-239244) on Kohler and Briggs-powered Portable generator sets with a new flashing board (A-228668). Observe the following safety warning and refer to Figures 1 and 2 when installing this kit.



WARNING

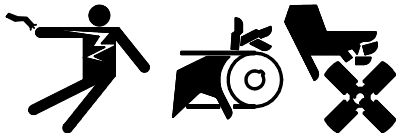

Accidental starting.

Can cause severe injury or death.

Disconnect battery cables before working on generator set (negative lead first and reconnect it last).

Accidental starting can cause severe injury or death. Disconnect the spark plug wire(s), remove battery cables (remove negative lead first and reconnect it last) and disconnect power to battery charger (if equipped) to disable generator set before working on any equipment connected to generator.

Parts Listing

Description	Qty.	Part Number
PCB Board Assembly	1	A-228668
Lock Washer #8	2	X-22-7
Screw 8-32 x 0.75	2	X-51-11 or X-31-6*
Fiber Spacer	2	X-712-2
Hex Nut, 8-32	2	X-72-4

* X-51-11 is to be used if replacing a flat head screw, X-31-6 is to be used if replacing a countersunk head screw.

Installation

(For units with the flashing board located in the end bracket - Earlier Kohler and Briggs-powered)

1. Disconnect the spark plug lead. If the unit is battery-equipped, disconnect the battery, negative lead first.
2. Remove the generator stator cover screws and lift off the cover.
3. Clip the tie wraps at the in-line fuse.
4. Unscrew the voltage regulator from its mounting bracket. Disconnect leads from the voltage regulator and remove.
5. Remove the four screws to access the power panel. Disconnect all leads running to the power panel in order to separate the panel from the generator set.
6. Raise the brushes in the holder, pushing the leads upward in slots. Retain the brushes in the holder by inserting a wire (brush) retainer.
7. Support the carrying frame with wood blocks at the generator end and place an additional wood block under the stator shell. Remove two vibro mount screws and lock nuts.
8. Disassemble four overbolts and remove vibro mounts and bracket. Use a rubber mallet to loosen the end bracket from the stator shell.
9. Disconnect F- lead and 66 lead(s) from the flashing board. There are two 66 leads if the unit has an econothrottle board and one 66 lead if the unit does not have an econothrottle board.

Remove and discard the flashing board and its mounting hardware.

10. Install the new flashing board (A-228668) in the same location in the end bracket as the old flashing board. Use hardware supplied in kit to secure. See Figure 1.

NOTE

Be sure that the flashing board does not make contact with the rotor turns. Push down any rotor end turns that extend excessively.

11. Reconnect F- lead and 66 lead(s) to the appropriately marked terminals.
12. Reinstall the end bracket to the stator using a rubber mallet. Replace vibro mounts and stator bracket. Install four overbolts and washer attaching the stator bracket and the end bracket to the generator adapter. Torque the overbolts according to the specification in the service manual. Remove the wood blocks from under the stator and carrying frame.
13. Remove the wire (brush) retainer and check brush alignment.
14. Reconnect the leads to the power panel. Make sure all leads are positioned away from the rotor.

NOTE

Leads in the end bracket must be firmly secured with cable ties to prevent damage during generator operation.

15. Mount power panel to the end bracket using four screws.
16. Reconnect leads to the voltage regulator. Secure the voltage regulator to the mounting bracket.
17. Tie wrap the in-line fuse to the overbolt.

NOTE

The new flashing board has a High Temperature Cut-out. If restarting a hot unit, some delay may occur before voltage is present.

18. Replace the generator stator cover.
19. Connect the spark plug wire and battery, if applicable (negative lead last).

Installation

(For units with the flashing board located underneath the stator shell cover - Newer Kohler-powered)

1. Disconnect the spark plug lead. If the unit is battery-equipped, disconnect the battery, negative lead first.
2. Remove the stator shell cover to expose the flashing board.
3. Disconnect F- lead and 66 lead(s) from the flashing board. There are two 66 leads if the unit has an econothrottle board and one 66 lead if the unit does not have an econothrottle board. See Figure 2 for the flashing board location.
4. Remove the old flashing board (D-239244) and discard.
5. Mount the new flashing board (A-228668) using the existing hardware or the hardware provided in the kit. See Figure 2.
6. Reconnect F- lead and 66 lead(s) to the appropriately marked terminals.

NOTE

The new flashing board has a High Temperature Cut-out. If restarting a hot unit, some delay may occur before voltage is present.

7. Replace the stator shell cover.
8. Connect the spark plug wire and battery, if applicable (negative lead last).

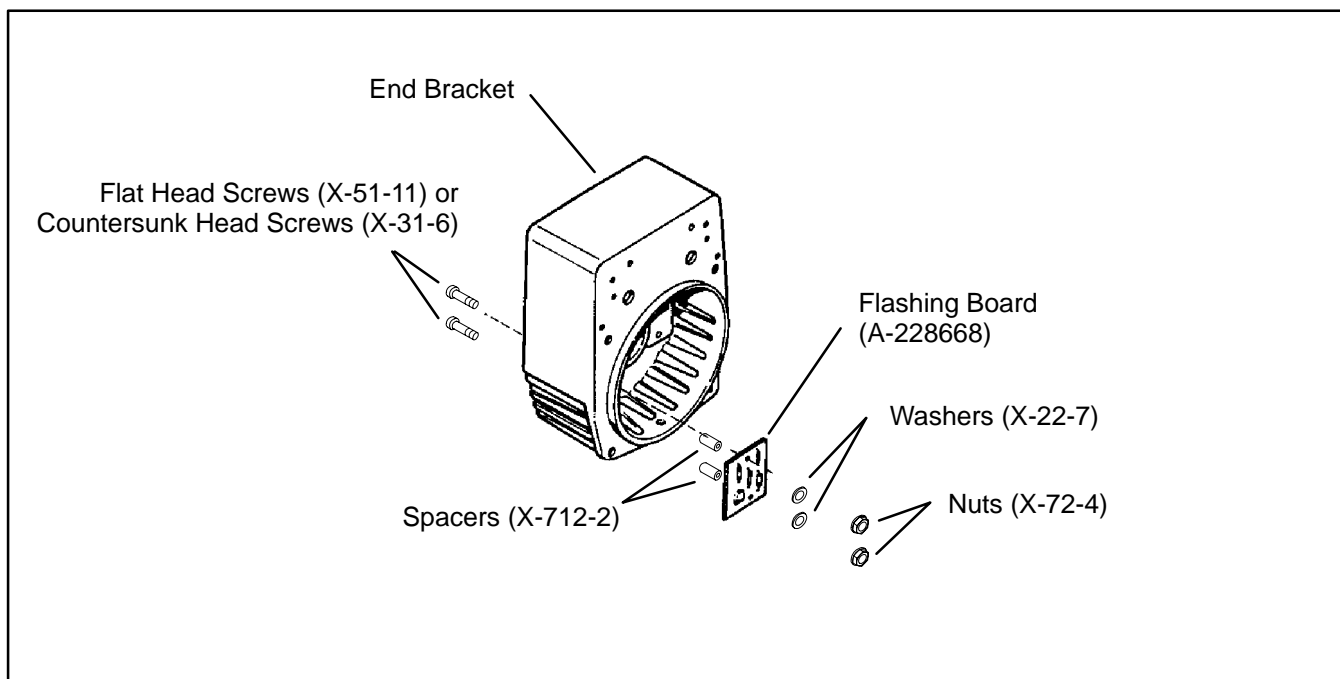

Figure 1. Flashing Board Location When Mounted In The End Bracket.

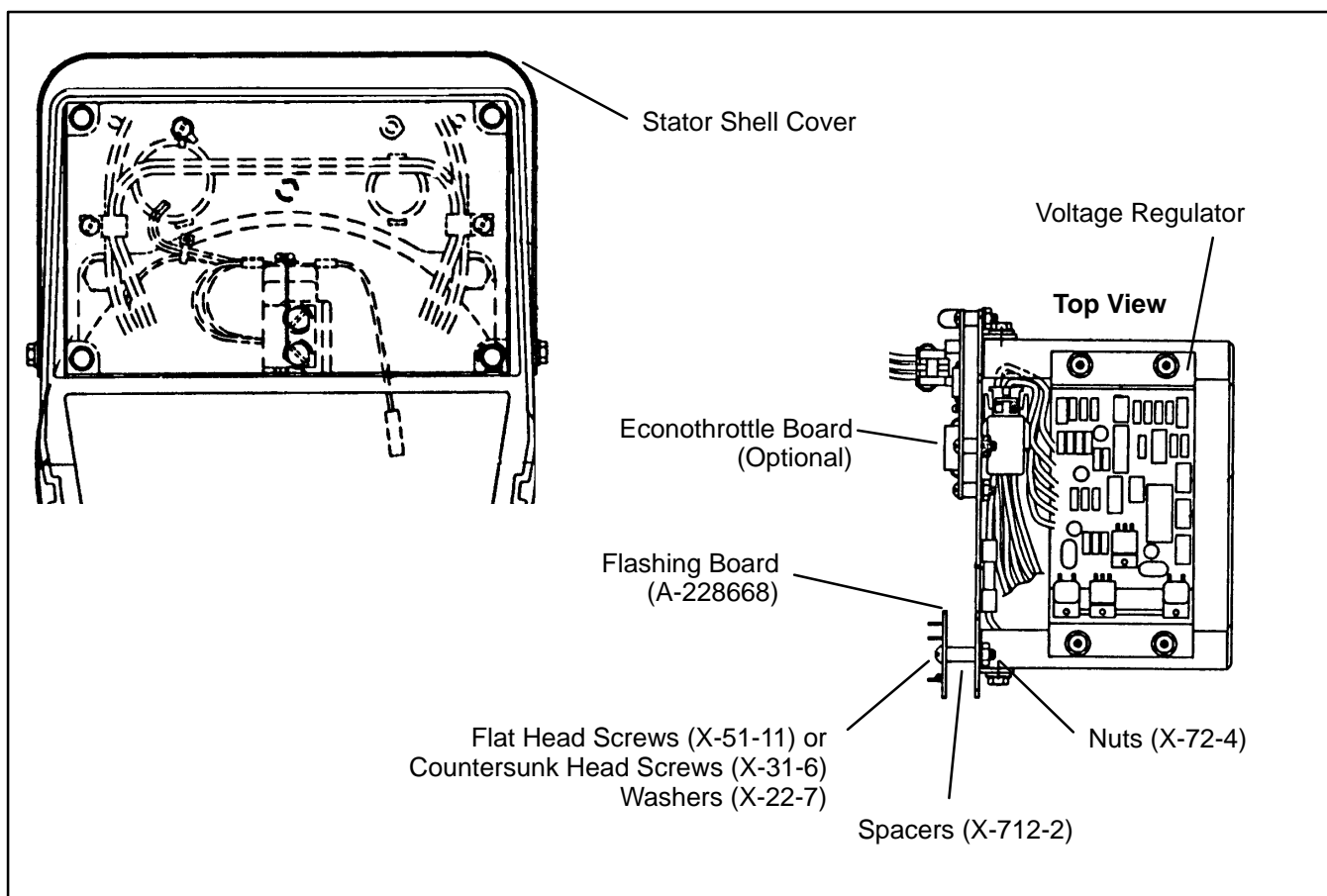

Figure 2. Flashing Board Location When Mounted Underneath Stator Shell Cover.