

INSTALLATION INSTRUCTIONS

Original Issue Date: 2/15

Model: **80-150REOZJF, 125REOZJG Generator Sets**

Market: **Industrial**

Subject: **Intake Hood Snow Package Kits GM94570-KP1 and GM95390-KP1**

Introduction

The following procedure covers the steps for installing an intake hood kit onto an enclosure. The primary purpose of an intake hood is to prevent snow and water from entering an enclosure and damaging the generator set. An intake hood is a required feature on the following enclosures: **GM93767-KA1, GM94132-KA1, and GM94132-KA2.**

Note: The intake hood kits cannot be retrofitted to older enclosures for models **80REOZJF, 100REOZJF, 125REOZJG, 150REOZJF.** See Figure 1 for enclosure and intake hood compatibility.

Model	Enclosure Kit	Intake Hood Snow Package Kit
80REOZJF	GM93767-KA1	GM95390-KP1
100REOZJF	GM93767-KA1	
125REOZJG	GM94132-KA1	GM94570-KP1
150REOZJF	GM94132-KA2	

Figure 1 Intake Hood Compatibility

Special Consideration

Get assistance as needed when lifting and securing the panels during the installation.

Safety Precautions

Observe the following safety precautions while installing the kit.

WARNING

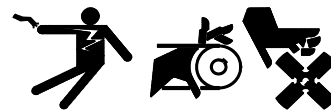

Accidental starting.
Can cause severe injury or death.

Disconnect the battery cables before working on the generator set. Remove the negative (-) lead first when disconnecting the battery. Reconnect the negative (-) lead last when reconnecting the battery.

Disabling the generator set. Accidental starting can cause severe injury or death. Before working on the generator set or connected equipment, disable the generator set as follows: (1) Move the generator set master switch to the OFF position. (2) Disconnect the power to the battery charger. (3) Remove the battery cables, negative (-) lead first. Reconnect the negative (-) lead last when reconnecting the battery. Follow these precautions to prevent starting of the generator set by an automatic transfer switch, remote start/stop switch, or engine start command from a remote computer.

(Decision-Maker® 550 Controllers)

Disabling the generator set. Accidental starting can cause severe injury or death. Before working on the generator set or equipment connected to the set, disable the generator set as follows: (1) Press the generator set off/reset button to shut down the generator set. (2) Disconnect the power to the battery charger, if equipped. (3) Remove the battery cables, negative (-) lead first. Reconnect the negative (-) lead last when reconnecting the battery. Follow these precautions to prevent the starting of the generator set by the remote start/stop switch.

(Decision-Maker® 3000 and 6000 Controllers)

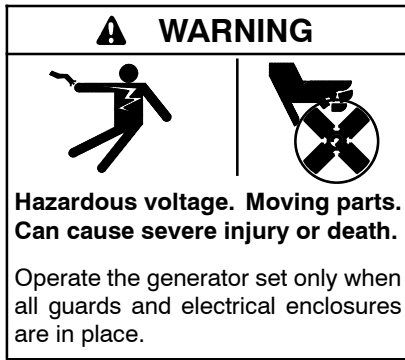

Grounding electrical equipment. Hazardous voltage can cause severe injury or death. Electrocutation is possible whenever electricity is present. Ensure you comply with all applicable codes and standards. Electrically ground the generator set and related equipment and electrical circuits. Turn off the main circuit breakers of all power sources before servicing the equipment. Never contact electrical leads or appliances when standing in water or on wet ground because these conditions increase the risk of electrocution.

Connecting the battery and the battery charger. Hazardous voltage can cause severe injury or death. Reconnect the battery correctly, positive to positive and negative to negative, to avoid electrical shock and damage to the battery charger and battery(ies). Have a qualified electrician install the battery(ies).

Short circuits. Hazardous voltage/current can cause severe injury or death. Short circuits can cause bodily injury and/or equipment damage. Do not contact electrical connections with tools or jewelry while making adjustments or repairs. Remove all jewelry before servicing the equipment.

Installation Procedure

1. Remove the generator set from service.

- 1.1 **Controllers: Decision-Maker® 550.** Place the generator set master switch to the OFF/RESET position.

OR

Controllers: Decision-Maker® 3000 and Decision-Maker® 6000. Press the generator set master control OFF/RESET button.

- 1.2 Disconnect the power to the battery charger, if equipped.

- 1.3 Use the battery disconnect switch (if equipped) to disconnect the battery or disconnect the generator set engine starting battery(ies), negative (-) lead first.

Note: Do not remove the louver motor cover during the intake hood installation. Utility power is supplied to the louver motor. Removing the louver motor cover exposes the power source. See Figure 3.

- 1.4 Disconnect the power to the louver motor by opening the circuit breaker.

2. Install the intake hood kit.

Note: The intake hood kit must be disassembled before installation.

- 2.1 To disassemble the intake hood kit, remove the screws connecting the top hood panel, side panels, and bottom grill.

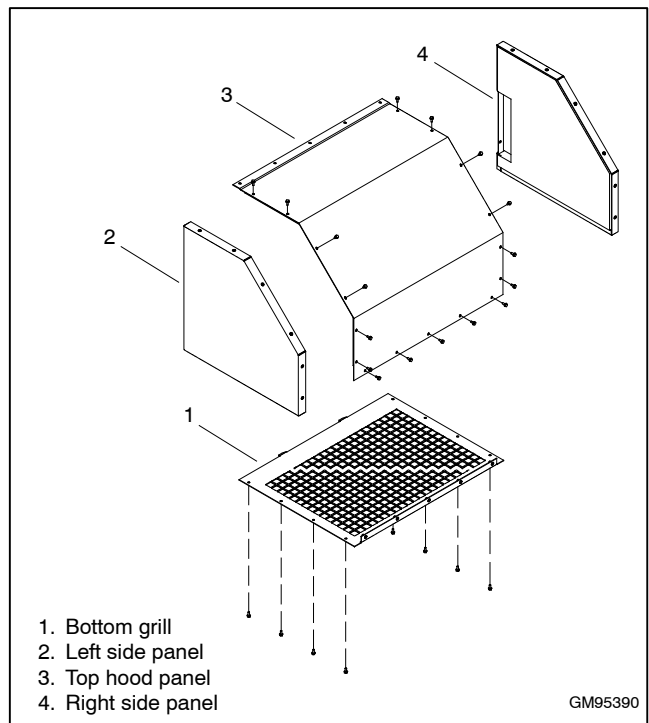

Figure 2 Intake Hood Disassembly

Note: The screws for securing the intake hood and side panels to the enclosure are installed on the enclosure and do not ship with the intake hood. Remove the screws from the enclosure prior to the installation. See Figure 3.

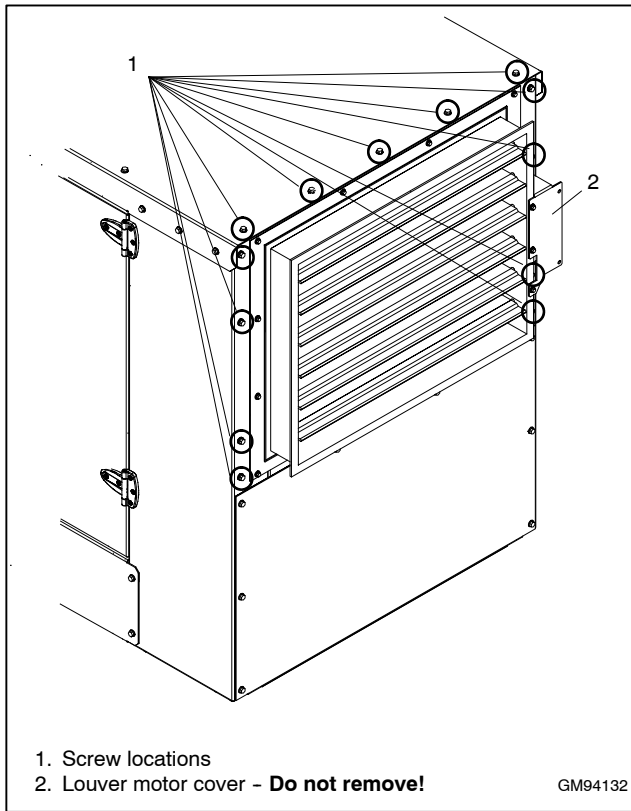

Figure 3 Mounting Screw Locations

- 2.2 To support either side panel during installation, partially thread a screw into the top screw hole locations on the enclosure. Use the slotted hole in the side panel to align the side panel with the partially threaded screw on the enclosure. See Figure 4.

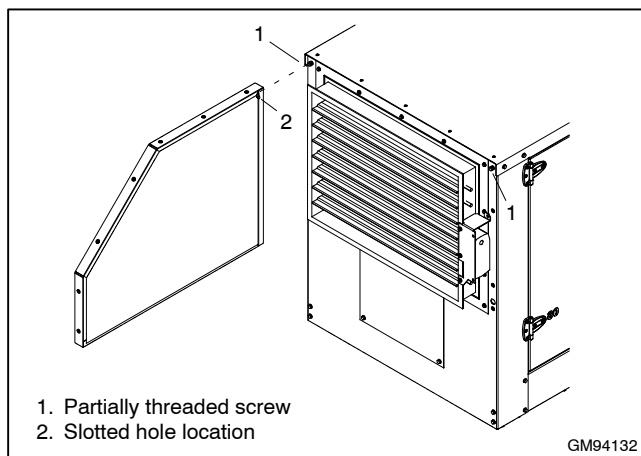

Figure 4 Side Panel Installation

- 2.3 Secure the side panel with four screws. Repeat the installation process for the second side panel.
- 2.4 Secure the top hood panel to the enclosure and the side panels.
- 2.5 To attach the bottom grill, insert the grill tabs into the enclosure slots and then secure the grill to the side panels and top hood panel. See Figure 5.

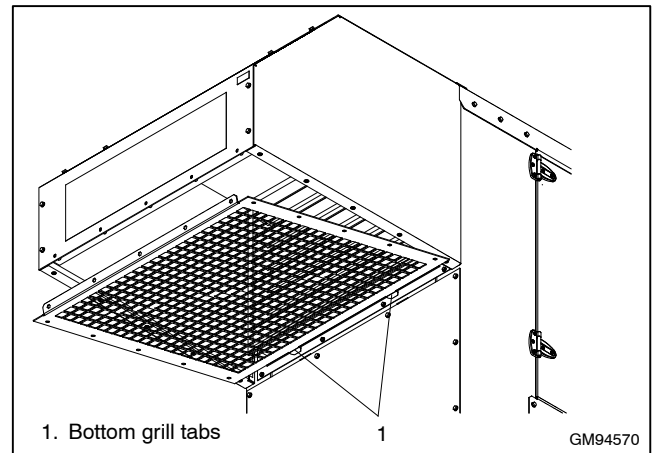

Figure 5 Bottom Grill Installation

3. Restore power to the generator set.

- 3.1 **Controllers: Decision-Maker® 550.** Place the generator set master switch to the AUTO or RUN position as required.

OR

Controllers: Decision-Maker® 3000, and Decision-Maker® 6000. Press the generator set master control AUTO or RUN button as required.

- 3.2 Use the battery disconnect switch (if equipped) to reconnect the battery or reconnect the generator set engine starting battery, negative (-) lead last.
- 3.3 Reconnect power to the battery charger, if equipped.
- 3.4 Reconnect the power to the louver motor by closing the circuit breaker.

Parts List

Intake Hood Snow Package Kit

Kit: GM94570-KP1		
Qty.	Description	Part Number
1	Panel, Intake (LH)	GM94139
1	Panel, Intake (RH)	GM94140
1	Panel, Intake Hood	GM94141
1	Grill, Intake	GM94142
1	Insulation, Acoustic Foam	GM94581
29	Screw, Hex Flange M8 x 20	M6921-08020-60
1	Instruction, Installation	TT-1649
Kit: GM95390-KP1		
Qty.	Description	Part Number
1	Panel, Intake, LH	GM93769
1	Panel, Intake, RH	GM93770
1	Panel, Intake Hood	GM93771
1	Grill, Intake	GM93777
1	Intake Hood Foam Kit	GM95391
25	Screw, Hex Flange M8 x 20	M6921-08020-60
1	Instruction, Installation	TT-1649

Availability is subject to change without notice. Kohler Co. reserves the right to change the design or specifications without notice and without any obligation or liability whatsoever. Contact your local Kohler® generator set distributor for availability.