

100RZ FAST-RESPONSE II OIL COOLER KIT 255922

Parts Used

Illustration Key Fig.'s 1 & 2	Application Notes	Description	Part Number	Quantity
1	Order one, if required for anticipatory Two required for anticipatory	Hose 5/8 x 21 in.	X-577-24	1
2		Hose 5/8 x 29 in.	X-577-26	1
3		Fitting 3/8 NPT x 5/8 in.	X-582-2	1
4		Hose Clamp	X-426-12	4
5		Oil Cooler	255888	1
6		Connector	255890	1
7		Elbow 1/2 in., 90°	X-211-1	1
8		Oil Pressure Switch	255912	1
9		Oil Pressure Switch	255913	1
10		Wire Lead, Ground	LN-1808-1613	1
11		Decal	255879	1
12		Fitting 1/2 NPT x 5/8 in.	X-582-1	1
13		Oil Filter	255942	1
14		Tie Wrap	X-468-1	2

CAUTION

Be sure that generator set is disconnected from load before starting work. Trip line circuit breakers (if equipped) to OFF position. Check to see that transfer switch is in "normal" position, with selector switch OFF.

WARNING

ELECTRICAL SHOCK! Battery can cause electrical burns and shocks. Exercise reasonable care when working near the battery to avoid electrical connections through tools. Remove wristwatch, rings, and any other jewelry.

WARNING

UNITS STARTS WITHOUT NOTICE! Units with Automatic Transfer Switches start automatically. Potential injury or electrocution can result. Turn Generator Master Switch on controller to OFF position, and remove battery cables, negative (-) lead first, to disable the generator set, before working on generator set or any connected equipment.

Installation

1. Place Generator Set Master switch in OFF position. Remove present oil filter. Clean filter mating surface on engine and threaded filter stud with nonflammable solvent. Allow to dry.
2. Lubricate oil cooler gasket with engine oil and press gasket into groove on oil cooler (see Figure 1).
3. Clean threads, and apply "Loctite" thread-locking compound to inner threads only of oil cooler connector (6) supplied with kit.
4. Place oil cooler body over the oil cooler connector with cooler gasket towards engine. Position cooler body with hose connections pointing forward as shown in Figure 1.
5. Secure oil cooler to engine with oil filter connector as shown in Figure 1. Tighten until oil filter connector is fitting snugly with gasket against engine, then tighten connector with another 3/4 turn. Wait 20 minutes for "Loctite" to cure, before installing filter.
6. Drain two gallons of coolant from radiator. Remove hose connection elbow from switch-sender block and replace with elbow (7) supplied with kit (see Figure 1). Use thread sealer when installing new elbow.

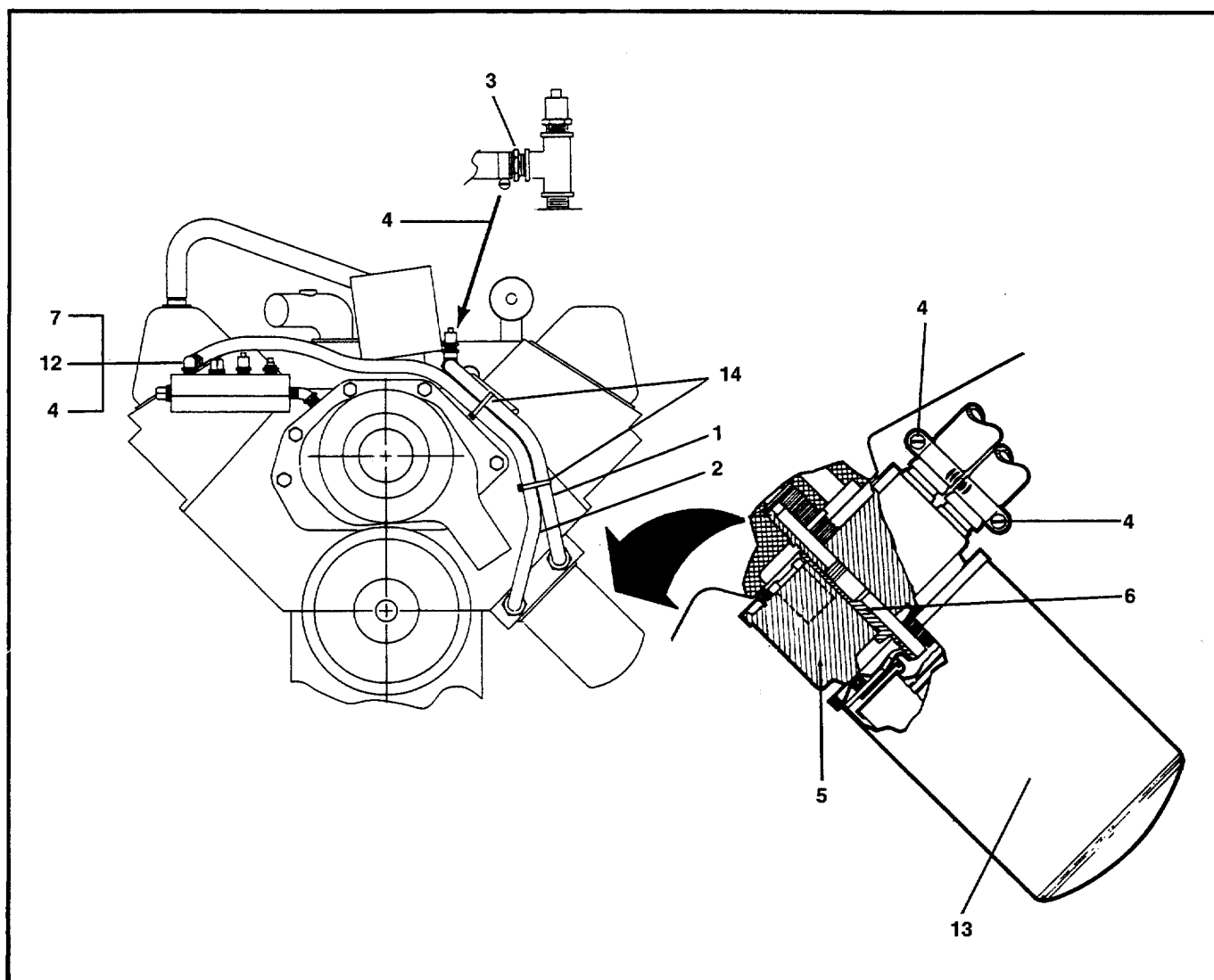

Figure 1. Oil Cooler Installation

7. Install hose connector fitting (12) on elbow, using thread sealer. Connect 29-inch hose (2) to hose connector fitting with hose clamp (4). Connect other end of hose to oil cooler, as shown in Figure 1, using hose clamp (4).
8. Remove original hose connector from tee on manifold, and replace with hose connector (3) as shown in Figure 1. Use thread sealer when installing new connector.
9. Attach 21-inch hose (1) to connector and oil cooler using hose clamps (4).
10. Remove original oil pressure switch(es) from switch block (see Figure 2 for location).
11. Install supplied oil pressure switch (8) using thread sealer. Attach ground lead (10) to switch as shown in Figure 2. Connect harness wire 13 to switch.

NOTE

If anticipatory low-oil pressure switch (9) is to be used, switch must be ordered separately.

12. If required, install anticipatory low-oil pressure switch (9) as described in Step 11.

CAUTION

For oil pressure switches to work properly they must be correctly connected. Connect harness wire 13 to low oil pressure switch (8). Connect harness wire 41A to anticipatory low oil pressure switch (9).

13. Install new oil filter. Add oil as necessary to bring oil level up to full mark on dip stick, OR, change oil to make sure it meets specifications shown below.

For Temperatures Usually Over	Use API Class
32°F (0°C) -10°F (-23°C)	20W50 or 40 10W40 or 10W50

14. Add coolant to radiator, filling to proper level, following engine manufacturers recommendations for coolant and mixture.

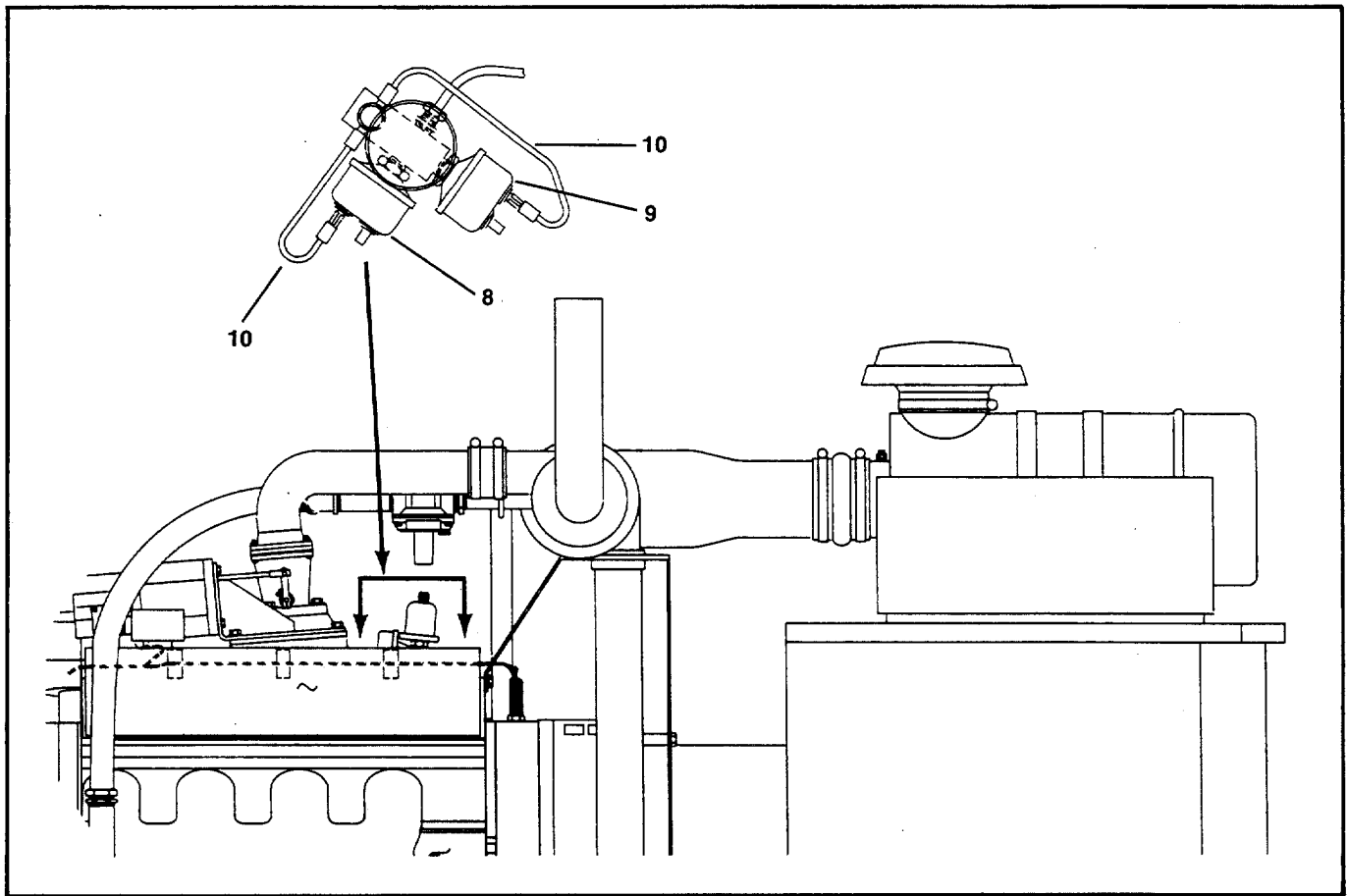

Figure 2. Oil Pressure Switch(es) Installation

15. Reconnect starting battery, negative (-) lead last.
16. Start generator set, and allow to warm up. Check for coolant and oil leaks. Repair leaks as required.
17. Stop generator set. Check oil and coolant levels. Add oil and coolant if necessary to bring up to proper levels.
18. Reset line circuit breakers, if necessary, and/or reset transfer switch for AUTOMATIC operation.
19. Apply decal (11) to left-bank valve cover, just below oil filler-breather cap.